

Vinewood



Cape Cod with Colonial Influence

This home combines an open floor plan in the kitchen, great room and breakfast room for casual everyday living with separate living and dining room for more formal entertaining. Off the kitchen, a large mudroom, half bath and laundry space make it easy to keep the house running. Main floor master suite; two additional bedrooms and a children's study upstairs.

Total Living Area: 3150 sq. footage

Main Floor: 2326 sq. footage

Upper Floor: 824 sq. footage

Lower Floor: 0

Width: 72'

Depth: 82'

2 Story

Bedrooms: 3

Main Floor Master Suite: Yes

Bathrooms: 2.5

Garage: 3

Vinewood Floor Plans

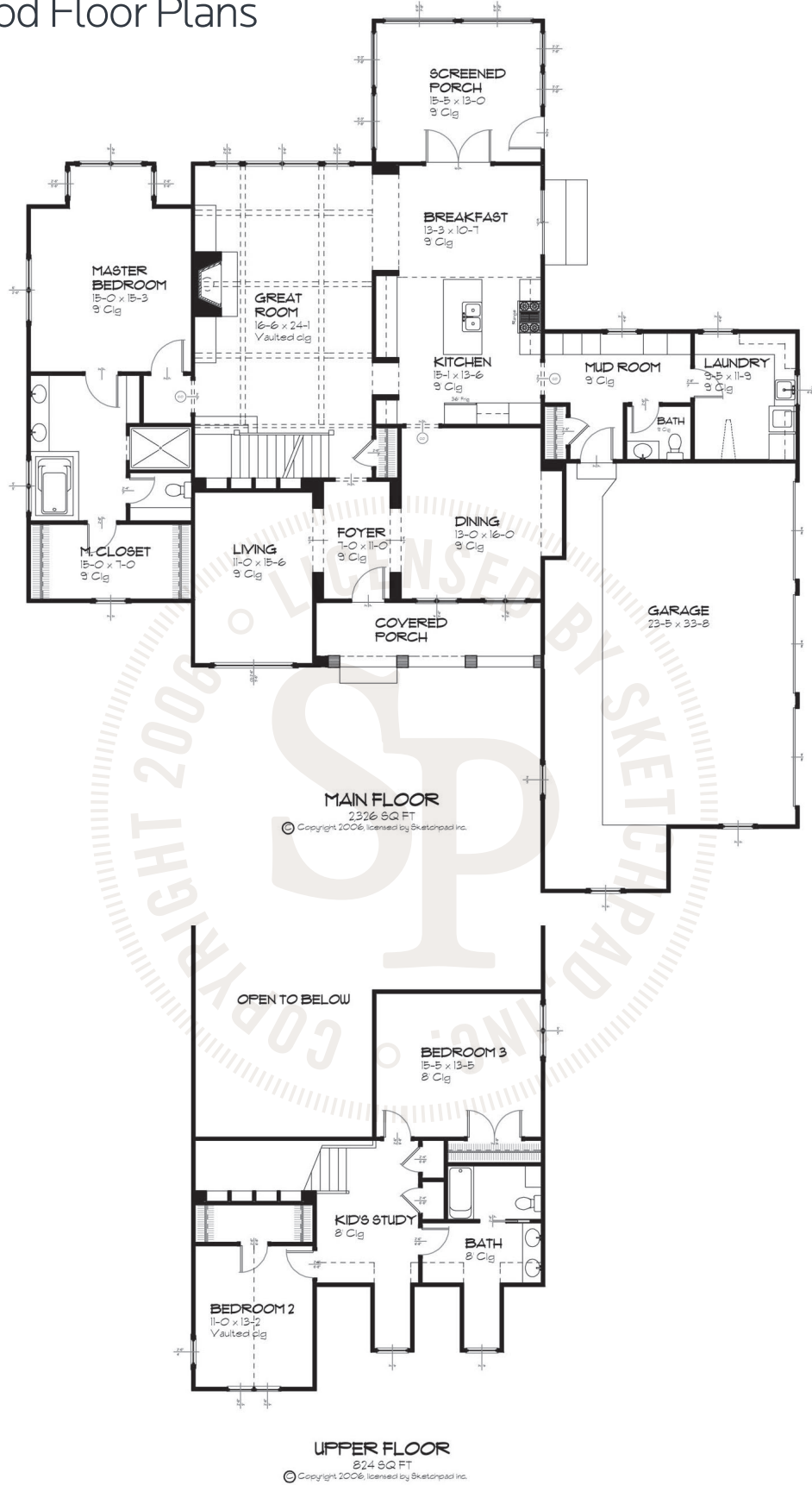

Vinewood Lake Elevations



FRONT ELEVATION
1/8" = 1'-0"

© Copyright 2006, licensed by Sketchpad Inc.



REAR ELEVATION
1/8" = 1'-0"

© Copyright 2006, licensed by Sketchpad Inc.



RIGHT ELEVATION
1/16" = 1'-0"

© Copyright 2006, licensed by Sketchpad Inc.



LEFT ELEVATION
1/16" = 1'-0"

© Copyright 2006, licensed by Sketchpad Inc.